

材料清单

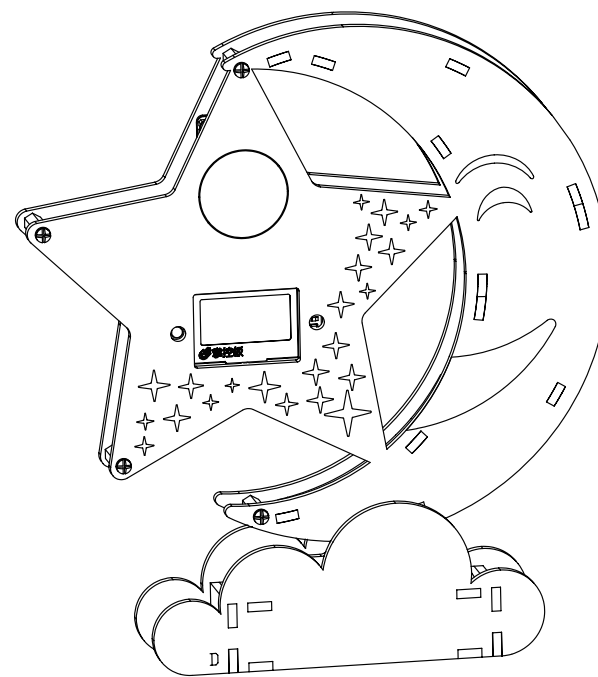

星月灯 组装及使用说明



在 <https://www.labplus.cn/topics> 页面内找到搜索框，搜索“星月灯”，打开对应作品案例，查看演示视频并下载程序。下载程序为压缩包，解压后需仔细阅读《使用必读》后根据要求将程序载入掌控板。

* 4RGB 灯接掌控拓展板 P13 接口。

材料清单

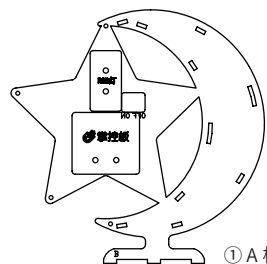

① A板 X1

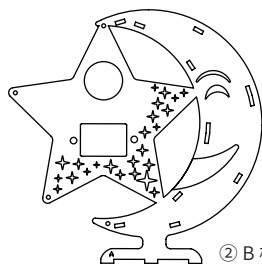

② B板 X1



③ D板 X1

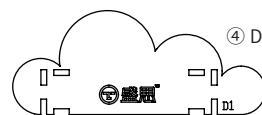

④ D1板 X1

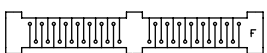

⑤ F板 X2

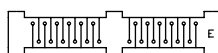

⑥ E板 X2

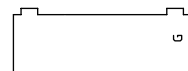

⑦ G板 X1

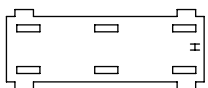

⑧ H板 X1



⑨ C板 X2



⑩ 光板 X1

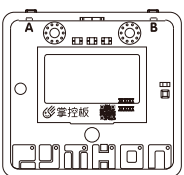

⑪ 掌控+拓展板 X1
(自备)



⑫ RGB灯 X1



⑬ M3X8mm 螺丝 X8



⑭ 铆钉 S4060 X2



⑮ 铆钉 S4080 X2



⑯ M3*15mm 铜柱 X4



⑰ 胶水 X1



⑱ 十字螺丝刀 X1

① >>>>>>>>

A 板 X1
光板 X1

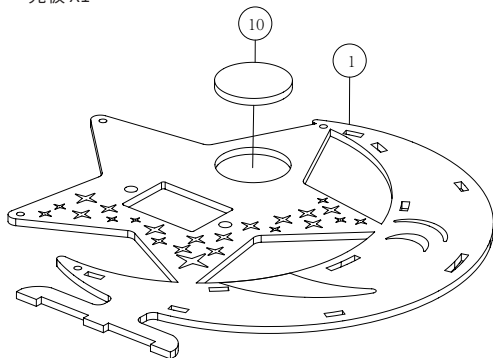

② >>>>>>>>

RGB 灯 X1
掌控 + 拓展板 X1
M3*15mm 铜柱 X4
M3X8mm 螺丝 X4
铆钉 S4060 X2
铆钉 S4080 X2

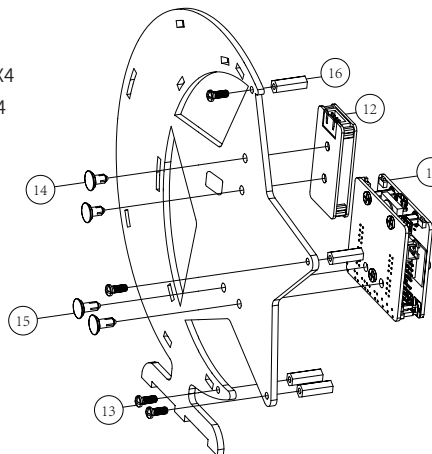

③ >>>>>>>>

E 板 X2
F 板 X2

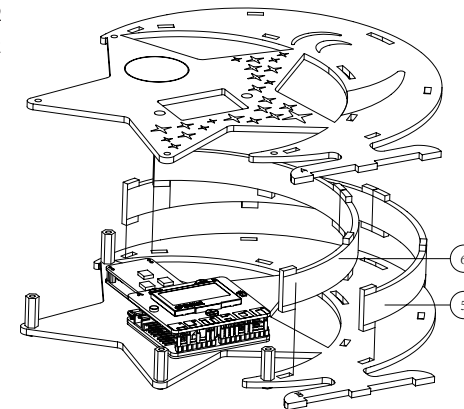

组装前
将 RGB 接入掌控拓展板，
并载入程序测试

④ >>>>>>>>

M3X8mm 螺丝 X4

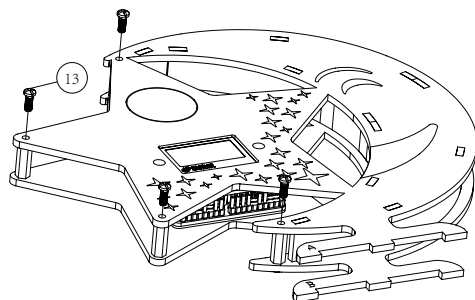

⑤ >>>>>>>>

C 板 X2
D 板 X1
D1 板 X1
G 板 X1
H 板 X1

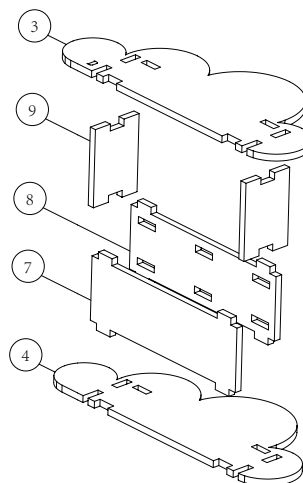

⑥ >>>>>>>>

